

**DELHI DEVELOPMENT AUTHORITY
ROHINI PROJECT PLANNING & DESIGN**

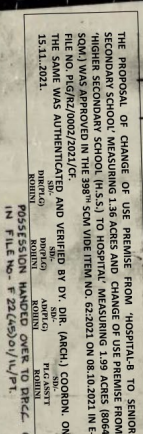

SECTOR XY
CHANGE OF USE PREMISE FROM "HIGHER SECONDARY SCHOOL, (H.S.), TO HOSPITAL" IS APPROVED IN THE BUREAU'S ACTION ITEM NO. 62-2021 ON 08-10-2021 IN E-FILE NO. P/R/K/0002/2021/G.

SUB DIVISION OF THIS SITE IS APPROVED BY V.C. ON 20-3-2023 IN FILE NO. P/R/K/00212021/P/S/14.

THE PROPOSAL WAS APPROVED IN 344th SCREENING COMMITTEE MEETINGS HELD ON 16.11.2016
VIDE ITEM NO 113: 2016
THE SAME HAS BEEN VERIFIED BY DY DIRECTOR (MCH),
COORD. ON 01.12.2016 IN FILE NO PPR/1072/92/15P-4/b

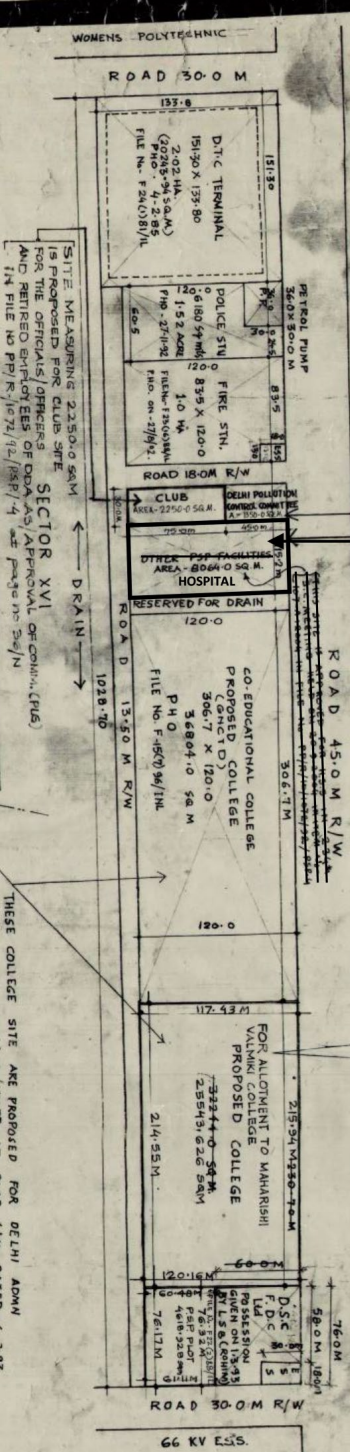

SECTOR XVI
IS PROPOSED FOR CLUB SITE
FOR THE OFFICIALS/OFFICERS
AND RETIRED EMPLOYEES OF DDA AS APPROVAL OF COMIN. (PUS
IN FILE NO PP/R/1672/92/RSP/4 at page no 5e/n

THESE COLLEGE SITE ARE PROPOSED FOR DELHI ADMN
VIDE FILE NO F-15(1)33/INSTT AT PAGE 4/N DATED-6-2-93

PLOT WITH AN AREA OF 260 AC
 HAS BEEN CHANGED FROM ILLEGAL
 TO HOSPITAL (DEATH ADMINISTRATION)
 APPROVED BY COM. (PLG) ON DATED 17-8-93
 VIDE FILE NO P/P/R/1096/PT/97

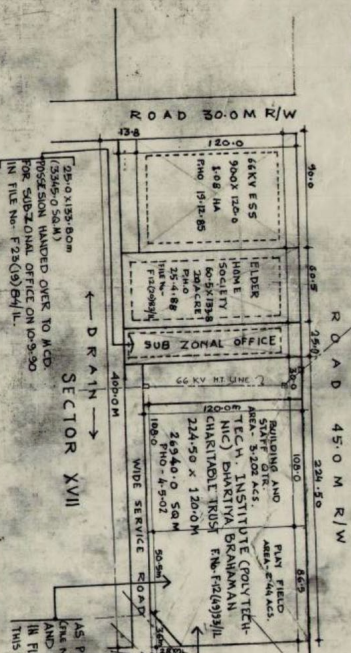

COPIES OF THIS DOCUMENT ARE BEING
FORWARDED TO THE
FEDERAL BUREAU OF INVESTIGATION
IN FILE NO. F23(19)84/11.

AS PER THE APPROVAL OF COMMR. (PLG) DT. 25-2-2000
THE P/RI/104/1997) THE COLLECT SHT WAS BEEN RETAINED
AND NAMED OVER TO BHAGYINI BRAHMAN CHAKRABARTI 1805
IN FILE NO. P-37-62(4) 29/1/17 WHO WERE ALREADY ALLOTTED
THIS LAND BY LANDS DEPARTMENT.

PUBLIC AND SEMI PUBLIC
AREA - 4

DATE - 8-7-96

SCALE 1:2000

DRG. NO. P-32

...

TOTAL AREA OF SITE = 25.80 HAc (63.75 ACs)

1-2: $550 \times 113.80 = 74,925.92$ SQM

3-4: $1028.70 \times 113.80 = 137640.06$ SQM

5-6: $400.0 \times 113.80 = 45520.00$

NET AREA UNDER PILOTS = 258065.98 SQM

FOR PLOT 1 WITH AREA LESS THAN 20 ACRES (0.8 HAC)	
PERMISSIBLE COVER :	33 1/3 %
F. A. R.	100
MAXIMUM HEIGHT :	24.3 M (80'-0")
FOR PLOTS WITH AREA MORE THAN 20 ACRES (0.8 HAC)	
PERMISSIBLE COVER :	25 %
F. A. R.	190
MAXIMUM HEIGHT :	24.3 M (80'-0")
TOTAL FLOOR SPACE GENERATED :	
SET BACKS	

(ROAD WIDTH)

A	60.0 M	R/W	30.0 M
B	45.0 M	R/W	15.0 M
C	30.0 M	R/W	15.0 M
D	24.0 M	R/W	10.0 M
E	BELOW 14.0 M	R/W #	5.0 M

ON TWO ADJOINING PLOT SIDES

IF OTHER THEN MARKED PHOTO ARE

EXTENDED ONLY AND SUBJECT TO CHANGE

NOTE

SEE MARKS AS PER DISCUSSION ON

ED 21-90
 * SITE FOR ACP OFFICE HAS BEEN HANDED OVER TO
 21M-92 FILE NO 25 (8)/86/INSTT.
 NOTE
 PETROL PUMP SITE ARE APPROVED WIDE LETTER N
 PA/3011/4/89/PART-1 DATED 22.8.89.
 WOMENS POLYTECHNIC SITE WAS INCORPORATED
 WIDE FILE NO
 THIS DIR. HAS BEEN RETRACTED FROM Dtd NO P-4 CT 21